

ROLLIGON TIRES



FOR OFF-HIGHWAY, AGRICULTURAL,
AND ALL-TERRAIN MOBILE EQUIPMENT



40" x 50" - 12"

54" x 68" - 18"

54" x 68" - 18" TR

72" x 96" - 28" TR

- Superior Compliance to Environmental Requirements
- Largest Footprint
- High Floatation
- Excellent Shock Absorption
- Special Compounded Cut and Tear Resistant Rubber
- Operating Temperature range—90°F to 250°F (Special Formulation for Arctic & Desert Use)
- All Tires Manufactured in Rolligon's Own Plant
- Special Bead Guard—Protects Sidewall and Wheel
- Molded in Lugs—Not Vulcanized on Separately

TIRES AVAILABLE IN 3 GRADES

- Standard Grade
Penetration Resistance = To a 6 Ply rated nylon tire or 9 actual plies of rayon.
- Vidar V-2
Penetration Resistance = To a 12 Ply rated nylon tire or 20 actual plies of rayon.
- Vidar V-4
Penetration Resistance = To a 20 Ply rated nylon tire or 40 actual plies of rayon.
(Our V-4 tire will stop a 158 grain bullet fired from a 38 Caliber revolver with a 2" barrel from 15 feet.)

ROLLIGON CORPORATION

10635 Brighton Lane Stafford, Texas 77477 713-495-1140

40"x50"-12" ROLLIGON TIRE

Types—Lugged Only
for Axle Loading



This tire is available in three grades and one type.

- Standard Lugged
- Vidar V-2 Lugged
- Vidar V-4 Lugged

TIRE DIMENSIONS

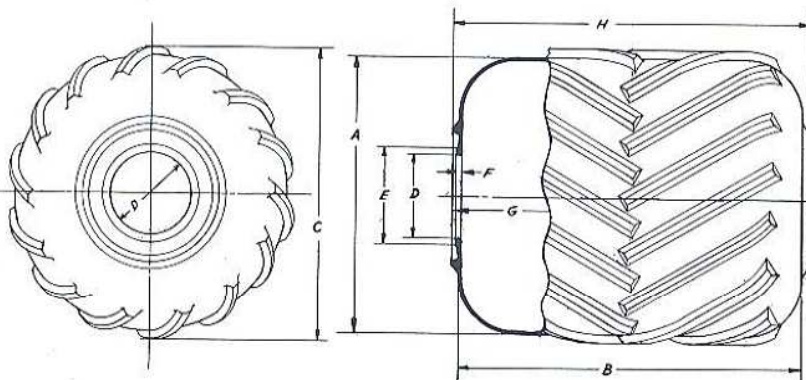

	In.	Cm.
A. Carcass Dia. _____	40.0	101.6
B. Carcass Width _____	50.0	127.0
C. Dia. over Lugs _____	42.5	108.0
D. Bead Hole I.D. _____	12.0	30.5
E. Bead O.D. _____	14.0	35.6
F. Bead Thickness _____	0.8	2.0
G. Width over Bead Faces _____	51.0	130.0
H. Width over Bead Guards _____	52.0	132.1

TIRE DATA

Weight, _____ 210 lbs. _____ 95 kgms. Max. Flotation, _____ 1750 lbs. _____ 794 kgms.

Average Footprint Area, _____ 750 sq. in. _____ 4840 sq. cm.

NOTE - Footprint Area varies to Inflation Pressure, Terrain Softness, and Tire Load

MAXIMUM TIRE LOAD-AXLE LOADED

Inflation Pressure, psi	2	4	6	8	10
Max. Tire Load, lbs.	1,000	2,000	3,000	4,000	5,000
Max. Tire Load, kgms.	453	907	1,360	1,815	2,268

Rolligon tires shown in this brochure are designed to be used on natural ground surfaces.

If used on surfaced roadways excessive wear will result.

All tire use applications and loadings shall be confirmed by Rolligon Corporation.



54" x 68" -18" ROLLIGON TIRE



U.S. Patent #3,799,617

Lugs and Top Roller Wear Pads

Lugs Only

TOP ROLLER

- Standard
- Vidar V-2
- Vidar V-4

Types—Lugs Only for Axle Loading: Wear Pads and Lugs for Top Roller Loading

LUGGED

- Standard
- Vidar V-2
- Vidar V-4

TIRE DIMENSIONS

Wear Pads and Lugs

Lugs Only

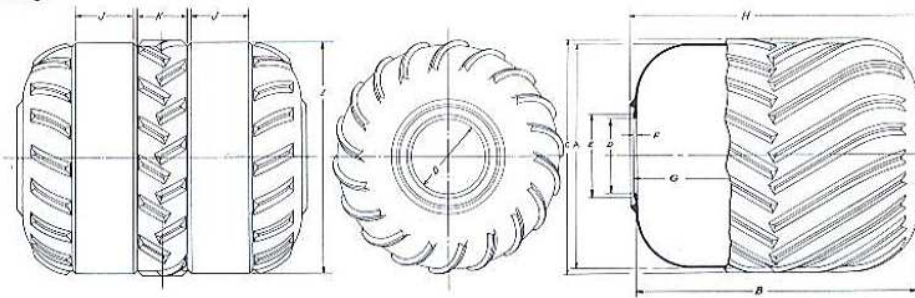

- A. Carcass Dia., _____ 54.0 in. ___ 137.2 cm.
- B. Carcass Width, _____ 68.0 in. ___ 172.7 cm.
- C. Dia over Lugs, _____ 56.5 in. ___ 143.5 cm.
- D. Bead Hole I.D., _____ 18.0 in. ___ 45.7 cm.
- E. Bead O.D., _____ 20.0 in. ___ 50.8 cm.
- F. Bead Thickness, _____ 0.8 in. ___ 2.0 cm.

- G. Width over Bead Faces, 69.0 in. ___ 175.3 cm.
- H. Width over Bead Guards, _____ 70.5 in. ___ 179.1 cm.
- I. Dia. over Wear Pads, _____ 55.5 in. ___ 141.0 cm.
- J.K. Wear Pad Width & Spacing, ___ 12, 14 in. ___ 30.5, 35.6 cm.

TIRE DATA

Weight, Lugs Only ___ 400 lbs. ___ 180 kgms.; Lugs and Top Roller Wear Pads ___ 500 lbs. ___ 230 kgms.
 Flotation _____ 5000 lbs. ___ 2268 kgms
 Average Footprint Area, _____ 1500 sq. in. ___ 9680 sq. cm.
 NOTE - Footprint Area Varies to Inflation Pressure, Terrain Softness, and Tire Load

MAXIMUM TIRE LOAD—AXLE LOADED

Inflation Pressure, psi	2	4	6	8	10
Max. Tire Load, lbs.	2,500	4,000	6,000	8,000	10,000
Max. Tire Load, kgms.	1,130	1,810	2,720	3,620	4,536

MAXIMUM TIRE LOAD—TOP ROLLER LOADED

	6	8	10	12	14	16
Max. Tire Load, lbs.	7,000	9,000	10,000	12,000	14,000	16,000
Max. Tire Load, kgms.	3,170	4,100	4,536	5,450	6,360	7,260

72"x96"-28" ROLLIGON TIRE

Types—Wear Pads and Lugs
for Top Roller Loading



This tire is available in one grade and one type.

- Vidar V-4—Top Roller

U.S. Patent #3,799,617

TIRE DIMENSIONS

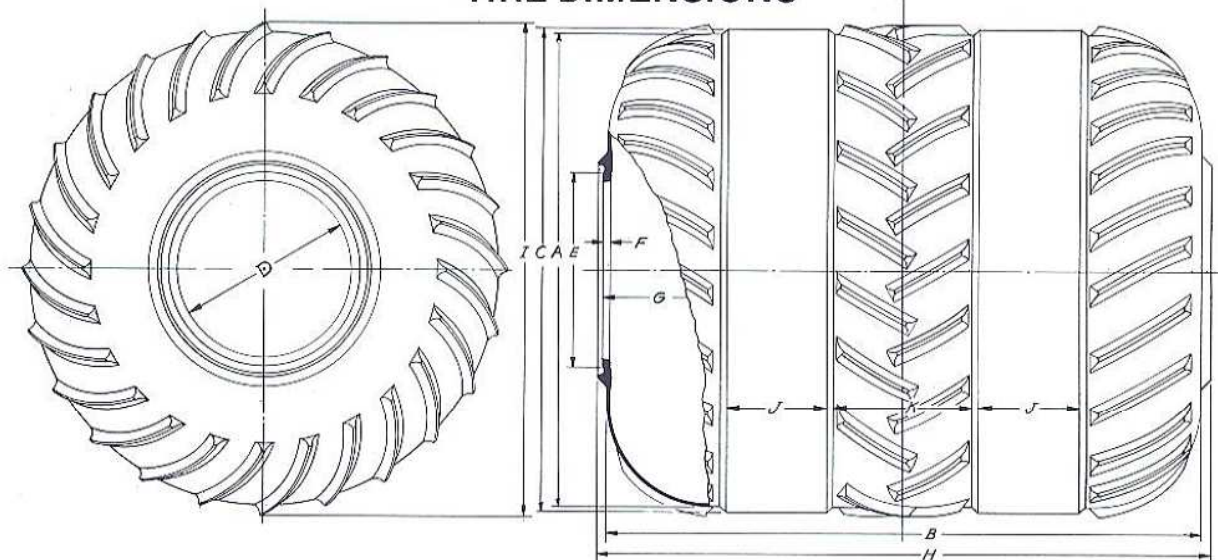

A. Carcass Dia.,	72.0 in.	183.0 cm.	G. Width over Bead Faces,	97.0 in.	246.4 cm.
B. Carcass Width,	96.0 in.	244.0 cm.	H. Width over Bead Guards,	98.5 in.	250.2 cm.
C. Dia. over Lugs,	75.0 in.	190.5 cm.	I. Dia. over Wear Pad Width,	74.0 in.	188.0 cm.
D. Bead Hole I.D.	28.0 in.	71.1 cm.	J. Wear Pad Width,	16.0 in.	40.6 cm.
E. Bead O.D.,	31.0 in.	78.7 cm.	K. Wear Pad Spacing,	23.5 in.	59.7 cm.
F. Bead Thickness,	0.8 in.	2.0 cm.			

TIRE DATA

Weight, 1150 lbs. 522 kgms. Max. Flotation, 13,000 lbs. 5897 kgms.
Average Footprint Area, 3000 sq. in. 1.94 sq. meter

NOTE: Footprint area varies to Inflation Pressure, Terrain Softness, and Tire Load

MAXIMUM TIRE LOAD—TOP ROLLER LOADED

Inflation Pressure, psi	6	9	12	15	18
Max. Tire Load, lbs.	12,000	18,000	24,000	30,000	36,000
Max. Tire Load, kgms.	5,450	8,160	10,900	13,600	16,300

ROLLIGON CORPORATION

Low Ground Pressure Tires

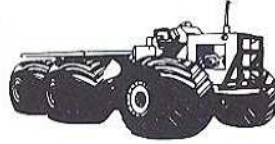

ROLLIGON CORPORATION
 Manufacturer of Special Ground Equipment



72x68-28 Tires



54x68-25 Tires



72x68-28 Tires



40x50-12 Tires

- High Flotation
- Vidar Protected Rubber
- Low Ground Compaction
- Cushions Impact Shocks
- Fits Most Axles
- Various Ply Ratings
- Low Rolling Resistance
- Engineered And
Manufactured To Meet
Your Off-Road Tire
Requirements

“Go Anywhere Any Time”

TIRE MODEL	OVERALL DIAMETER		OVERALL WIDTH		BEAD OPENING ID		BEAD THICKNESS		TREAD DEPTH		STATIC LOADED RADIUS		ROLLING CIRCUMFERENCE		FOOTPRINT AREA		WHEEL WEIGHT		TIRE WEIGHT		DISPLACEMENT		MAX TIRE LOAD		MAX TIRE PRESSURE		MAXIMUM SPEED	
	in	cm	in	cm	in	cm	in	cm	in	cm	in	cm	in	cm	in ²	cm ²	lbs	kg	lbs	kg	lbs	kg	lbs	kg	psi	kPa	mph	km/hr
40 X 50-12 V2	42.5	108	52.0	132.1	12.0	30.5	0.8	2.0	1.3	3.2	17.0	43.2	126	320	1000	6450	50	23	275	125	1750	793.8	5000	2268	15	103	25	40.2
40 X 50-12 V4	42.5	108	52.0	132.1	12.0	30.5	0.8	2.0	1.3	3.2	17.0	43.2	126	320	1000	6450	50	23	300	136	1750	793.8	5000	2268	15	103	25	40.2
54 X 68-18 V2	56.5	144	70.5	179.1	18.0	45.7	0.8	2.0	1.3	3.2	25.0	63.5	170	432	1800	11600	265	120	480	218	5000	2268	16000	7257	25	172	25	40.2
54 X 68-18 V4	56.5	144	70.5	179.1	18.0	45.7	0.8	2.0	1.3	3.2	25.0	63.5	170	432	1800	11600	265	120	540	245	5000	2268	16000	7257	25	172	25	40.2
54 X 68-18 V6	56.5	144	70.5	179.1	18.0	45.7	0.8	2.0	1.3	3.2	25.0	63.5	170	432	1800	11600	265	120	595	270	5000	2268	16000	7257	25	172	25	40.2
54 X 68-25 V2	56.5	144	70.5	179.1	25.0	63.5	0.8	2.0	1.3	3.2	25.0	63.5	170	432	1800	11600	265	120	470	213	5000	2268	16000	7257	25	172	25	40.2
54 X 68-25 V4	56.5	144	70.5	179.1	25.0	63.5	0.8	2.0	1.3	3.2	25.0	63.5	170	432	1800	11600	265	120	530	240	5000	2268	16000	7257	25	172	25	40.2
54 X 68-25 V6	56.5	144	70.5	179.1	25.0	63.5	0.8	2.0	1.3	3.2	25.0	63.5	170	432	1800	11600	265	120	580	263	5000	2268	16000	7257	25	172	25	40.2
72 X 68-28 V4	75.0	191	71.5	181.6	28.0	71.1	1.1 or 1.5	2.0 or 3	1.5	3.8	30.0	76.2	226	574	2850	18387	865	392	800	363	7500	3402	18000	8165	25	172	25	40.2
72 X 68-28 V6	75.0	191	71.5	181.6	28.0	71.1	1.1 or 1.5	2.0 or 3	1.5	3.8	30.0	76.2	226	574	2850	18387	865	392	1025	465	7500	3402	18000	8165	25	172	25	40.2
72 X 68-28 HDL	75.0	191	71.5	181.6	28.0	71.1	1.1 or 1.5	2.0 or 3	1.5	3.8	30.0	76.2	226	574	2850	18387	865	392	960	435	7500	3402	18000	8165	25	172	25	40.2

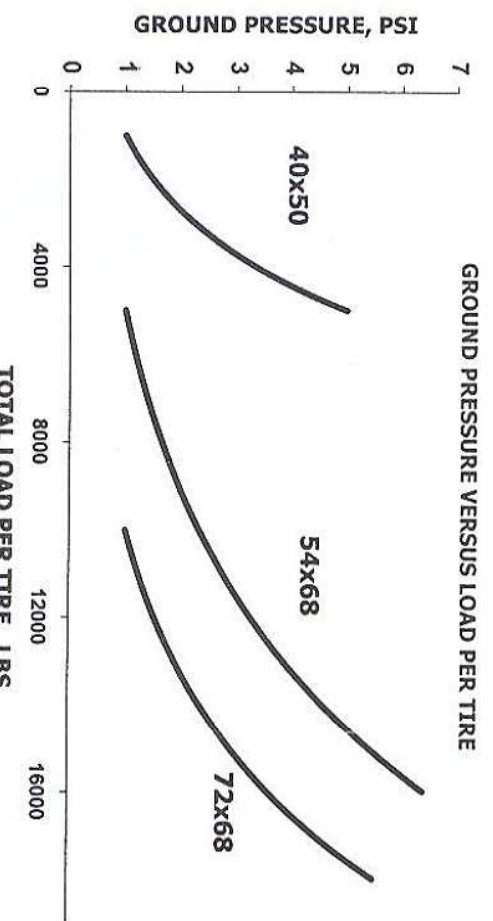
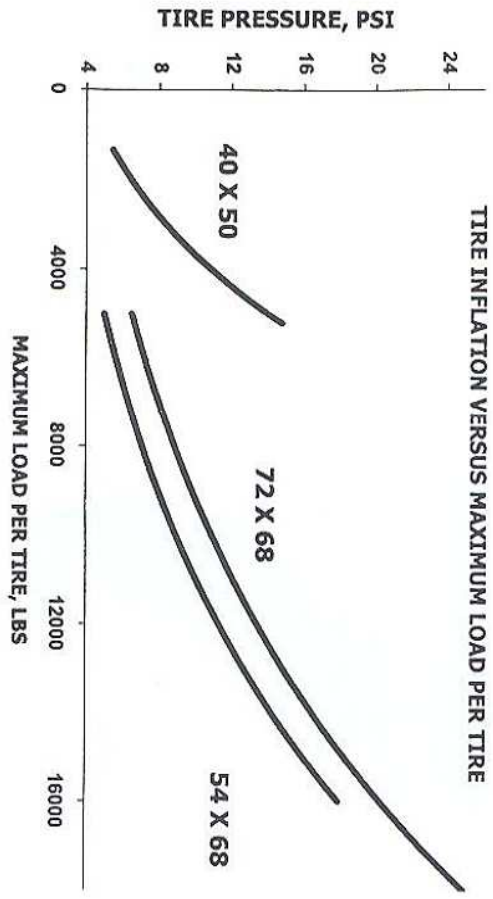

1. WHEELS MANUFACTURED TO FIT YOUR SPECIFIC VEHICLE.
2. TIRE SIZES OF 72X68-28 AND 72X68-28 AVAILABLE AS SPECIAL ORDER ITEMS.
3. MOST SIZES AVAILABLE WITHOUT LUGS FOR YOUR ENVIRONMENTALLY SENSITIVE APPLICATION.
4. ALWAYS FOLLOW TIRE INFLATION CHART FOR MAXIMUM TIRE PERFORMANCE AND LIFE.
5. FOOTPRINT AREA VARIES WITH INFLATION PRESSURE, TERRAIN SOFTNESS, AND TIRE LOAD.
6. ROLLIGON TIRES ARE MANUFACTURED FOR OFF ROAD USE. USE ON PAVED ROADWAYS WILL RESULT IN INCREASED WEAR.
7. U.S. AND FOREIGN PATENTS APPLY.
8. ALL TIRE APPLICATIONS SHALL BE CONFIRMED BY ROLLIGON CORPORATION.

For additional information please contact:

ROLLIGON CORPORATION

10635 BRIGHTON LANE
 STAFFORD, TEXAS 77477 U.S.A.
 TELEPHONE: (281) 495-1140
 FAX: (281) 495-1145
 INTERNET: www.rolligon.com

ROLLIGON HEAVY DUTY OFF ROAD TIRES

Low Pressure - Super Wide (LPSW)

72" x 68" - 28" ROLLIGON TIRE

Ideal For Log Skidder/Forwarder
Applications in Soft Ground.
(LT - Logger Special**)
Available in V2 - V4 - V6
& Logger Strength Grades



TIRE DIMENSIONS

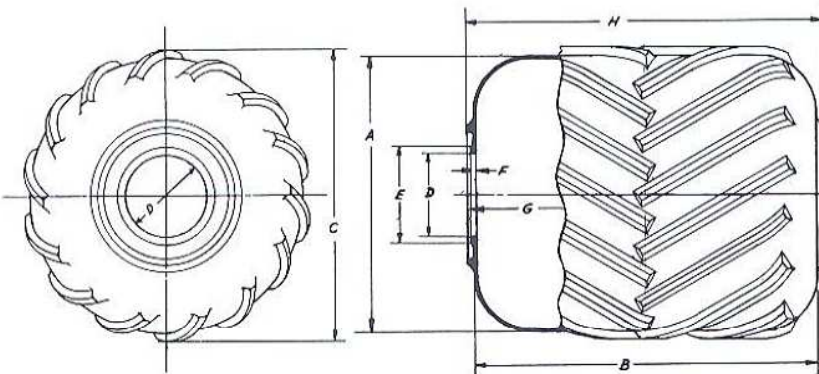

LPSW 68 V2	- 68" Wide	20 Ply
LPSW 68 V4	- 68" Wide	40 Ply
LPSW 68 V6	- 68" Wide	60 Ply
LPSW 68 LT	- 68" Wide	Logger
LPSW 82 V2	- 82" Wide	20 Ply
LPSW 82 V4	- 82" Wide	40 Ply
LPSW 82 V6	- 82" Wide	60 Ply
LPSW 82 LT	- 82" Wide	Logger

A. Carcass Dia., _____	72.0 in. 183.0 cm.	G. Width over Bead Faces, _____	69.0 in. 175.3 cm.
B. Carcass Width, _____	68.0 in. 172.7 cm.	H. Width over Bead Guards _____	71.5 in. 181.6 cm.
C. Dia. over Lugs, _____	75.0 in. 190.5 cm.		
D. Bead Hole I.D. _____	28.0 in. 71.1 cm.		
E. Bead O.D., _____	31.5 in. 80.0 cm.	Same Tire Available in 82 inch (208 cm)	
F. Bead Thickness, _____	1.2 in. 3.2 cm.	Tread width. Specify LPSW 82 (LT)**	

STANDARD TIRE DATA

Weight, V6: _____ 675 lbs. 306 kgms. Max. Flotation, _____ 7,500 lbs. 3402 kgms.
Average Footprint Area, _____ 2850 sq. in. 18,387 sq. cm.

NOTE: Footprint area varies to Inflation Pressure, Terrain Softness, and Tire Load

RECOMMENDED MAXIMUM TIRE LOAD – STANDARD MOUNTING

Inflation Pressure, psi	3	5	7	10	13	15
*Max. Tire Load, lbs.	3,250	5,000	7,000	13,300	15,500	17,687
Max. Tire Load, kgms.	1,474	2,268	3,175	6,032	7,027	8,023

** Loggins Tire Incorporates Special Sidewall Reinforcement.

When ordering specify: "LT" suffix.

* V-4 Tire. Retro fits on many off road vehicles with Wheel Adapter Kit #A10942.

Specification No. RT (8-89)

ROLLIGON TIRE

Low Pressure - Xtra Super Wide (LPXSW)

72''x96''-28''

Low Pressure — High Floatation Tire for Off Road Applications Only.

Tire Manufactured by Rolligon Corporation..

Cleats are an integral part of tire, molded into tire at curing – not glued on after cure.



This tire is available in three grades.

- Vidar V-2 = 20 ply rating
- Vidar V-4 = 40 ply rating
- Vidar V-6 = 60 ply rating

TIRE DIMENSIONS

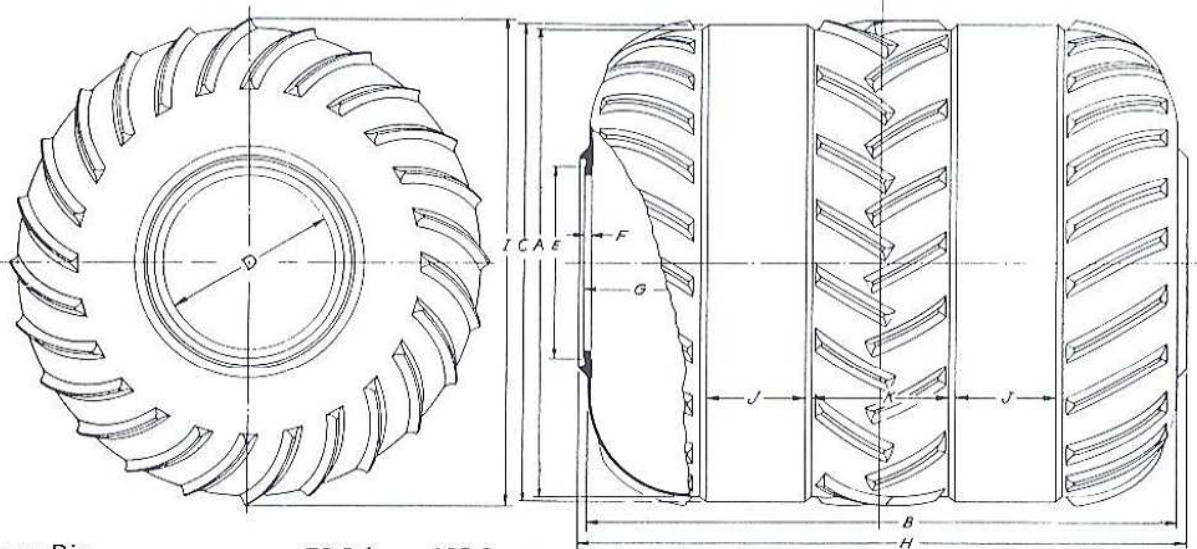

A. Carcass Dia., _____	72.0 in. 183.0 cm.	G. Width over Bead Faces, _____	97.0 in. 246.4 cm.
B. Carcass Width, _____	96.0 in. 244.0 cm.	H. Width over Bead Guards _____	98.5 in. 250.2 cm.
C. Dia. over Lugs, _____	75.0 in. 190.5 cm.	I. Dia. over Wear Pad Width, _____	74.0 in. 188.0 cm.
D. Bead Hole I.D. _____	28.0 in. 71.1 cm.	J. Wear Pad Width. _____	14.0 in. 35.5 cm.
E. Bead O.D., _____	31.0 in. 78.7 cm.	K. Wear Pad Spacing _____	26.0 in. 66.0 cm.
F. Bead Thickness, _____	1.2 in. 3.2 cm.		

STANDARD TIRE DATA

Weight, _____ 1275 lbs. 578 kgs. Max. Flotation, _____ 13,000 lbs. 5897 kgs.
 Average Footprint Area, _____ 3857 sq. in. 24,890 sq. cm.

NOTE: Footprint area varies to Inflation Pressure, Terrain Softness, and Tire Load

MAXIMUM TIRE LOAD — STANDARD MOUNTING

Inflation Pressure, psi	6	9	12	15	18
Max. Tire Load, lbs.	11,000	17,000	23,000	29,000	35,000
Max. Tire Load, kgs.	4,989	7,711	10,432	13,154	15,876

ROLLIGON CORPORATION

10635 Brighton Lane • Stafford, Texas 77477 U.S.A.

Telephone: (713) 495-1140 • Fax: (713) 495-1145 • Telex: 79-0515 Rolligon

Specification No. RT 777

40''x50''-12'' ROLLIGON TIRE

Types—Lugged Only
for Axle Loading

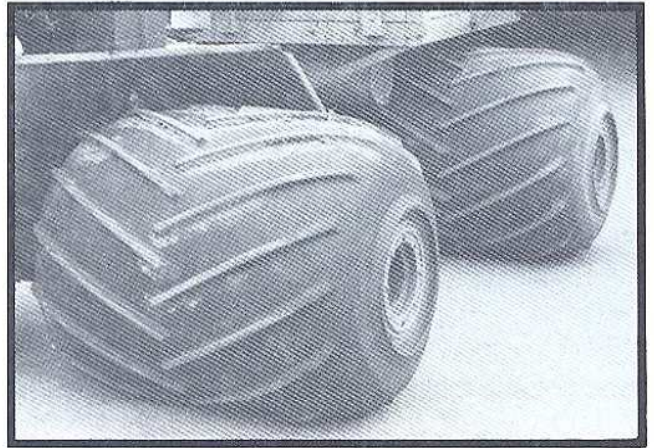

This tire is available in three grades and one type.

- Standard Lugged = 08 Ply Rating
- Vidar V-2 Lugged = 20 Ply Rating
- Vidar V-4 Lugged = 40 Ply Rating

TIRE DIMENSIONS

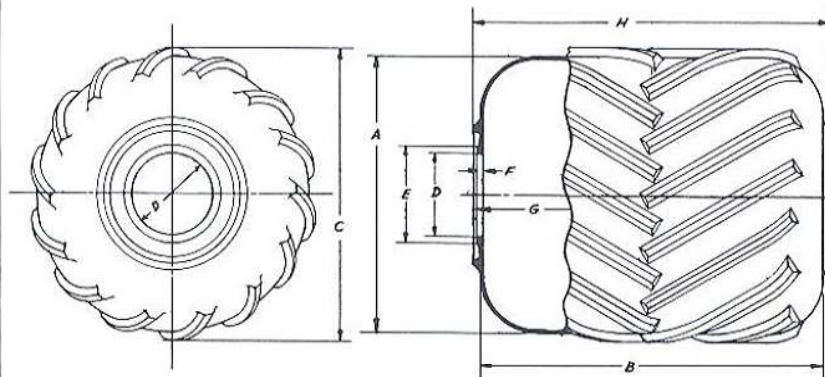

	In.	Cm.
A. Carcass Dia. _____	40.0	101.6
B. Carcass Width _____	50.0	127.0
C. Dia. over Lugs _____	42.5	108.0
D. Bead Hole I.D. _____	12.0	30.5
E. Bead O.D. _____	14.0	35.6
F. Bead Thickness _____	0.8	2.0
G. Width over Bead Faces _____	51.0	130.0
H. Width over Bead Guards _____	52.0	132.1

STANDARD TIRE DATA

Weight, _____ 275 lbs.____124.7 kgms. Max Flotation, ____1750 lbs.____794 kgms.
Average Footprint Area, _____ 1000 sq. in.____6,451 sq. cm.

NOTE: Footprint area varies to Inflation Pressure, Terrain Softness, and Tire Load

MAXIMUM TIRE LOAD — AXLE LOADED

Inflation Pressure, psi	2	4	6	8	10
Max. Tire Load, lbs.	1,000	2,000	3,000	4,000	5,000
Max. Tire Load, kgms.	453	907	1,360	1,815	2,268

Rolligon tires shown in this brochure are designed to be used on natural ground surfaces.

If used on surfaced roadways excessive wear will result.

All tire use applications and loadings shall be confirmed by Rolligon Corporation.

ROLLIGON CORPORATION

10635 Brighton Lane

Stafford, Texas 77477 U.S.A.

Telephone: (713) 495-1140; Fax: (713)495-1145

Telex: 79-0515 Rolligon

ROLLIGON TIRES



54" x 68"

- Full Body Cleat
- Top Roller Pads
- Smooth

U.S. Patent #3,799,617

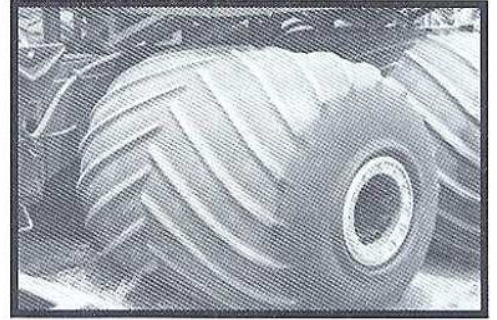

Lugs and Top Wear Pads

Lugs Only

- Ply Rating
- Standard = 08
 - Vidar V-2 = 20
 - Vidar V-4 = 40
 - Vidar V-6 = 60

Types—Lugs Only for Axle Loading: Wear Pads and Lugs and Smooth for Top Roller Loading

- Ply Rating
- Standard = 08
 - Vidar V-2 = 20
 - Vidar V-4 = 40
 - Vidar V-6 = 60

TIRE DIMENSIONS

Wear Pads and Lugs

Lugs Only

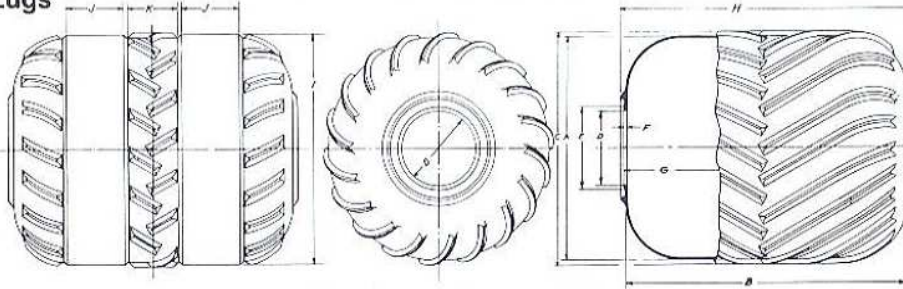

- | | |
|---|--|
| A. Carcass Dia., _____ 54.0 in. 137.2 cm. | G. Width over Bead Faces, _____ 69.0 in. 175.3 cm. |
| B. Carcass Width, _____ 68.0 in. 172.7 cm. | H. Width over Bead Guards _____ 70.5 in. 179.1 cm. |
| C. Dia. over Lugs, _____ 56.5 in. 143.5 cm. | I. Dia. over Wear Pads, _____ 55.5 in. 141.0 cm. |
| *D. Bead Hole I.D. _____ 18.0 in. 45.7 cm. | J. Wear Pad Width. _____ 12.0 in. 30.5 cm. |
| E. Bead O.D., _____ 20.0 in. 50.8 cm. | K. Wear Pad Spacing _____ 14.0 in. 35.6 cm. |
| F. Bead Thickness, _____ 0.8 in. 2.0 cm. | |

*Also available in 25.0 in (63.5 cm) Bead Opening

STANDARD TIRE DATA

Weight, Lugs Only _____ 400 lbs. _____ 180 kgms.; Lugs and Top Roller Wear Pads _____ 500 lbs. _____ 230 kgms.

Flotation, _____ 5,000 lbs. _____ 2268 kgms.

Average Footprint Area, _____ 1800 sq. in. _____ 11,612 sq. cm.

NOTE: Footprint area varies to Inflation Pressure, Terrain Softness, and Tire Load

MAXIMUM TIRE LOAD — AXLE LOADED

Inflation Pressure, psi	2	4	6	8	10
Max. Tire Load, lbs.	2,500	4,000	6,000	8,000	10,000
Max. Tire Load, kgms.	1,130	1,810	2,720	3,620	4,536

MAXIMUM TIRE LOAD — TOP ROLLER LOADED

	2	4	6	8	10	12	14	16
Max. Tire Load, lbs.	3,000	5,000	7,000	9,000	10,000	12,000	14,000	16,000
Max. Tire Load, kgms.	1,360	2,268	3,170	4,100	4,536	5,450	6,360	7,260

Lugs molded into tire carcass at cure - not glued on after cure.